

# INSTALLATION INSTRUCTIONS FOR FIFTH WHEEL LANDING GEAR FRONT 6,000# DOUBLE - ACTING JACK

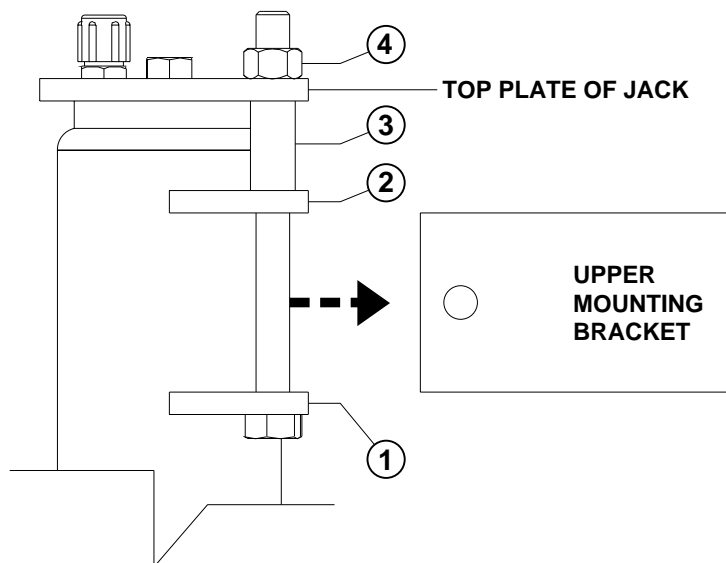
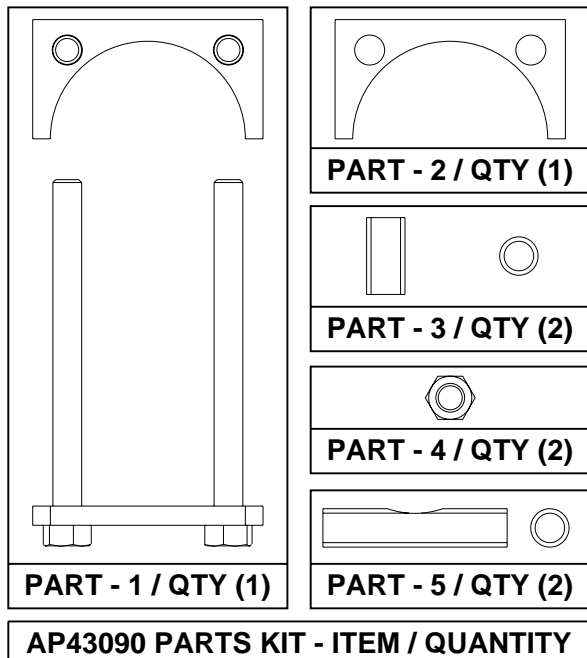

- Parts list (1 jack):
1. Lower support bracket with bolts - 1
  2. Upper support bracket - 1
  3. Support bracket spacers - 2
  4. Support bracket lock nuts - 2
  5. Mounting bracket spacers (notched) - 2

1. Install parts 1, 2, 3 and 4 onto the jack as shown. Apply the nuts (4) loosely.
2. Slide the jack assembly into the existing mounting brackets. Make sure the upper support bracket (2) is on the top of the upper mounting bracket. The lower support bracket (1) should be up against the bottom of the upper mounting bracket.
3. Install the top and bottom mounting bracket bolts using the mounting bracket spacers (5). The notch in the spacer goes against the barrel of the jack. Do not tighten these bolts yet.

**IMPORTANT:** If the existing bolts are not used, make sure the new bolts are a minimum of a grade 5 bolt.

4. Tighten the support bracket lock nut (4). Make sure the upper (2) and lower (1) support brackets are tight against the existing upper mounting bracket.
5. Tighten the mounting bracket nuts.

